

EASY OPEN PIPE HANGER INSTALLATION

TOOLS REQUIRED FOR INSTALLATION:

- * 9/16" WRENCH
- * 2 - 3/4" WRENCHES

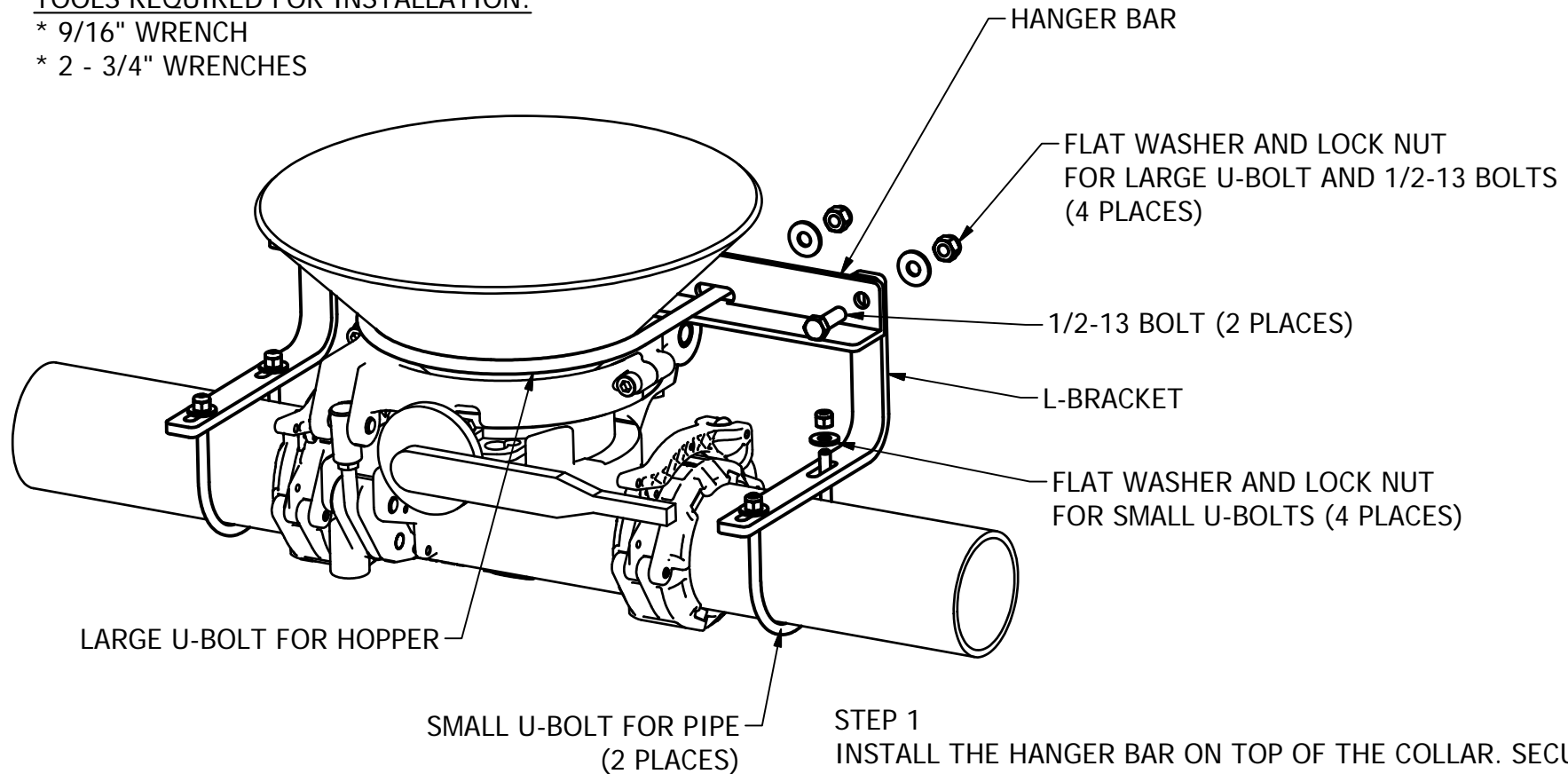

BEFORE INSTALLING PIPE HANGER KIT

- MAKE SURE EASY OPEN TEE IS PROPERLY INSTALLED AND ADJUSTED
- MAKE SURE PIPES ARE CUT TO GIVE PROPER 1/4" CLEARANCE TO END OF TEE
- CLAMP PIPES IN PLACE USING COUPLERS

STEP 1

INSTALL THE HANGER BAR ON TOP OF THE COLLAR. SECURE IT IN PLACE USING THE LARGE U-BOLT, WASHERS, AND LOCKNUTS. MAKE SURE THE HANGER BAR IS PARALLEL TO THE UNLOAD LINE BEFORE TIGHTENING NUTS.

STEP 2

ASSEMBLE THE L-BRACKETS AND SMALL U-BOLTS. HAND TIGHTEN THE NUTS AT THIS POINT.

STEP 3

ALIGN THE L-BRACKET WITH THE HANGER BAR AND THE SMALL U-BOLTS. TIGHTEN THE NUTS FOR THE SMALL U-BOLTS. FINALLY TIGHTEN THE NUTS FOR THE 1/2-13 BOLTS.